

**Appendix C**  
**Plan and Profile**



HIGHWAY 417

SPURDIE ROAD

WILLOW LEA

WESTBROOK

WALGREEN

1

V

IV

III

ROTHBOURNE

HAZELDEAN

DAVID MANCHESTER

XII

HAZELDEAN

16

17

18

19

20

21

XI

HAZELDEAN ROAD DRAIN

Location Plan  
Hazeldean Road  
Municipal Drain  
Goulbourn Ward  
May, 2010  
DOC. 1

Trans Canada Trail

X

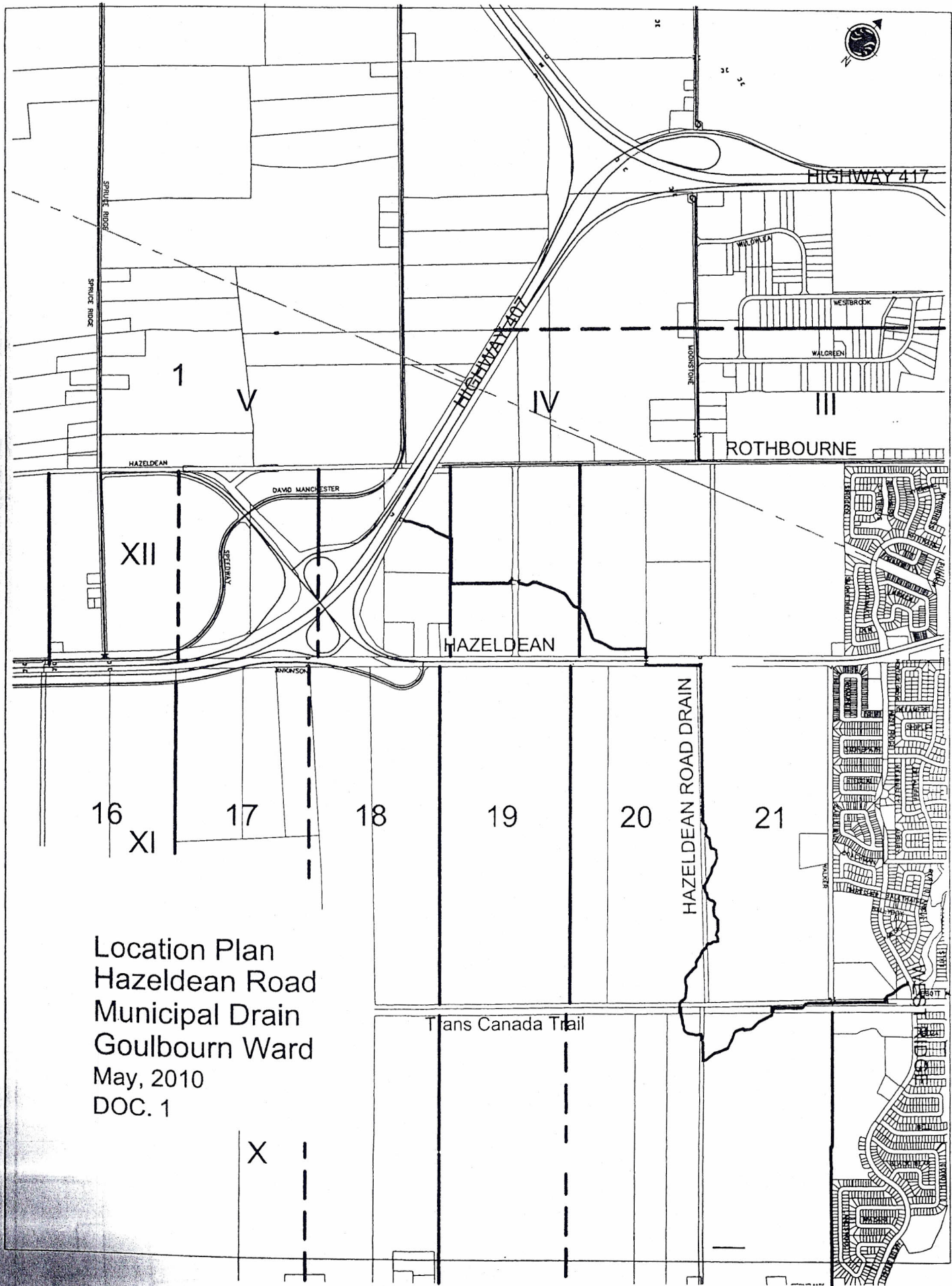

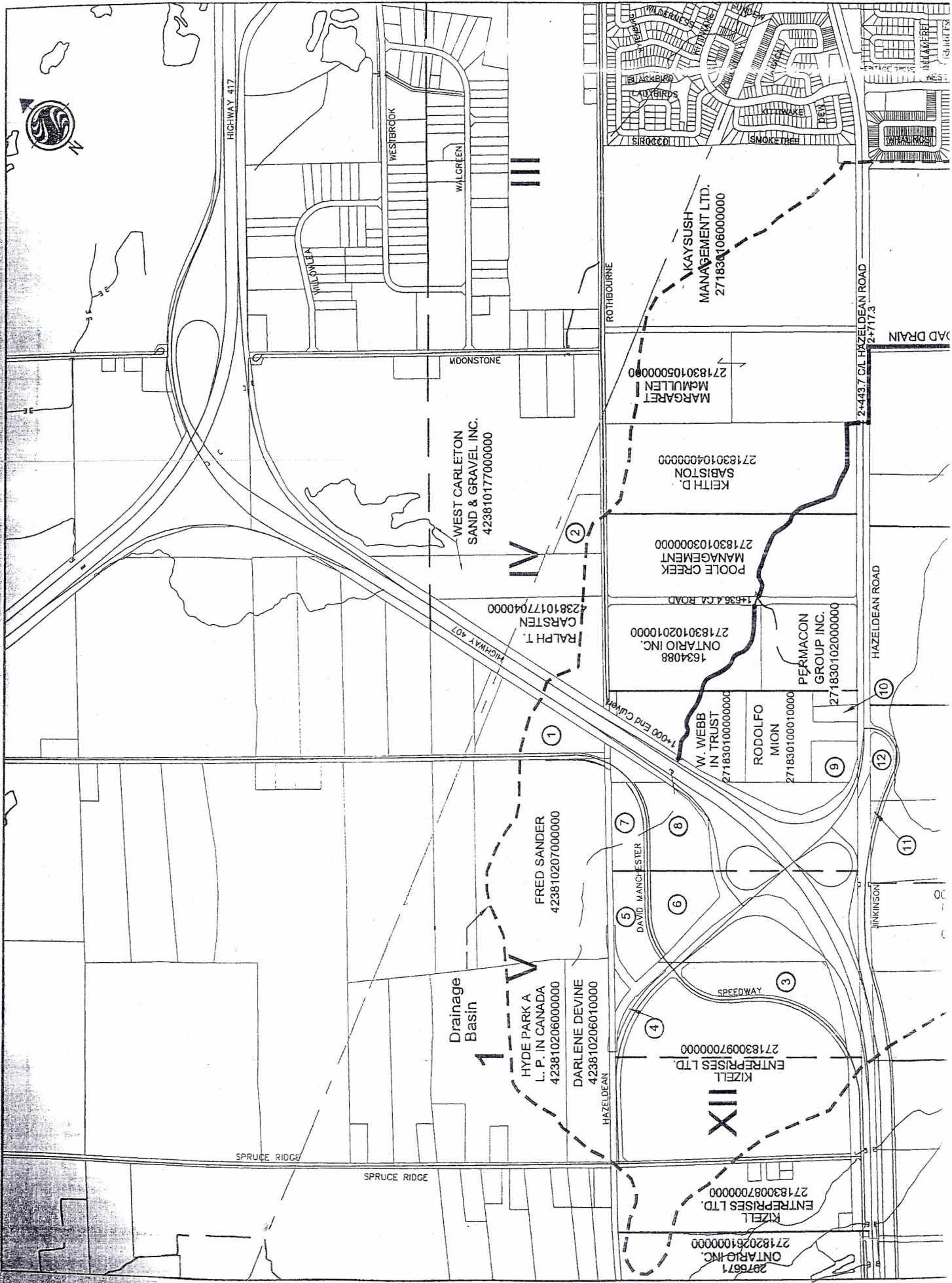

HIGHWAY 417

WESTBROOK

WALGREEN

WILLOWLEA

MOONSTONE

ROTHBOURNE

WEST CARLETON SAND & GRAVEL INC.  
423810177000000

RALPH T. CARSTEN  
423810177040000

FRED SANDER  
423810207000000

DARLENE DEVINE  
423810206010000

HYDE PARK A L.P. IN CANADA  
423810206000000

ONTARIO INC.  
271830102010000

W. WEBB IN TRUST  
271830100000000

RODOLFO MION  
271830100010000

DAVID MANCHESTER

KIZELL ENTERPRISES LTD.  
271830097000000

KIZELL ENTERPRISES LTD.  
271830087000000

ONTARIO INC.  
271820261000000

PEARMACON GROUP INC.  
271830102000000

POOL CREEK MANAGEMENT  
271830103000000

KEITH D. SABISTON  
271830104000000

MARGARET MULLEN  
271830105000000

KAYSUSH MANAGEMENT LTD.  
271830106000000

III

IV

XIII

Drainage Basin

1

2

3

4

5

6

7

8

9

10

11

12

SPRUCE RIDGE

SPRUCE RIDGE

2-443.7 CAL HAZELDEAN ROAD

2-717.3

HAZELDEAN ROAD

JINKINSON

AD DRAIN

2-443.7 CAL HAZELDEAN ROAD

2-717.3

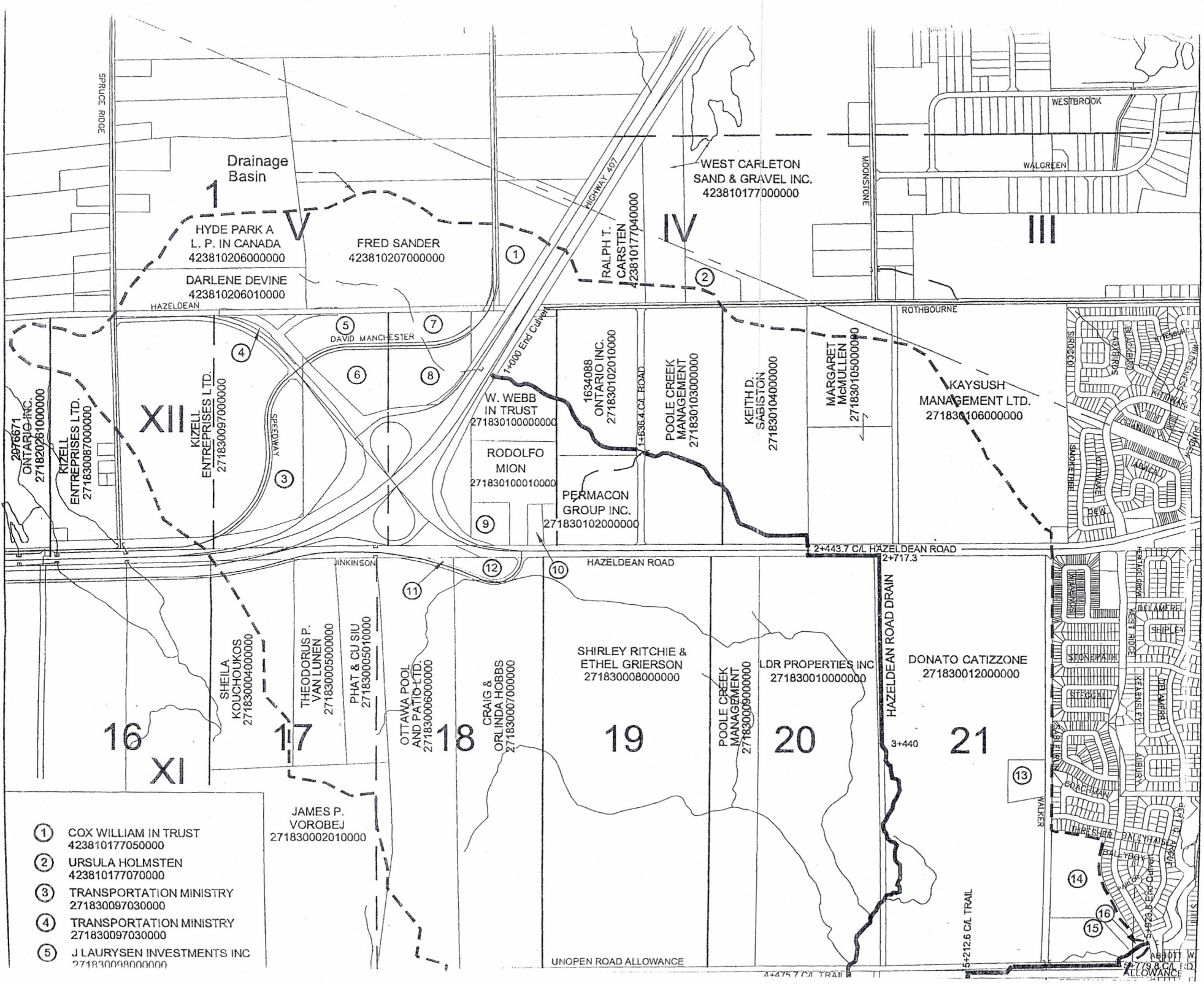

SPRUCE RIDGE

Drainage Basin

HYDE PARK A  
L. P. IN CANADA  
423810206000000

DARLENE DEVINE  
423810206010000

FRED SANDER  
423810207000000

WEST CARLETON  
SAND & GRAVEL INC.  
423810177000000

RALPH T.  
CARSTEN  
423810177040000

WESTBROOK

WALGREEN

HAZLEDEAN

DAVID MANCHESTER

W. WEBB  
IN TRUST  
271830100000000

1634088  
ONTARIO INC.  
271830102010000

POOLE CREEK  
MANAGEMENT  
271830103000000

KEITH D.  
SABISTON  
271830104000000

MARGARET  
McMULLEN  
271830105000000

KAYSUSH  
MANAGEMENT LTD.  
271830106000000

2076671  
ONTARIO INC.  
271820261000000

KIZELL  
ENTREPRISES LTD.  
271830087000000

XIII  
KIZELL  
ENTREPRISES LTD.  
271830097000000

RODOLFO  
MION  
271830100010000

PERMACON  
GROUP INC.  
271830102000000

ROTHBOURNE

2+443.7 C/L HAZLEDEAN ROAD

2+717.3

JINKINSON

HAZLEDEAN ROAD

16

XI

17

18

19

20

21

SHEILA  
KOUCHOUKOS  
271830004000000

THEODORUS P.  
VAN LUNEN  
271830005000000

PHAT & CU SIU  
271830005010000

OTTAWA POOL  
AND PATO LTD.  
271830006000000

CRAIG &  
ORLINDA HOBBS  
271830007000000

SHIRLEY RITCHIE &  
ETHEL GRIERSON  
271830008000000

POOLE CREEK  
MANAGEMENT  
271830009000000

LDR PROPERTIES INC  
271830010000000

DONATO CATIZZONE  
271830012000000

JAMES P.  
VOROBEJ  
271830002010000

- ① COX WILLIAM IN TRUST  
423810177050000
- ② URSULA HOLMSTEN  
423810177070000
- ③ TRANSPORTATION MINISTRY  
271830097030000
- ④ TRANSPORTATION MINISTRY  
271830097030000
- ⑤ J LAURYSSEN INVESTMENTS INC  
271830098000000

UNOPEN ROAD ALLOWANCE

4+475.7 C/L TRAIL

5+212.6 C/L TRAIL

WALKER

14

15

16

ABBOTT W  
4+798.8 C/L F.D.  
ALLOWANCE

16

XI

17

18

19

20

21

- ① COX WILLIAM IN TRUST  
423810177050000
- ② URSULA HOLMSTEN  
423810177070000
- ③ TRANSPORTATION MINISTRY  
271830097030000
- ④ TRANSPORTATION MINISTRY  
271830097030000
- ⑤ J LAURYSSEN INVESTMENTS INC  
271830098000000
- ⑥ J LAURYSSEN INVESTMENTS INC  
271830098020000
- ⑦ NANCY BEVAN IN TRUST  
271830099000000
- ⑧ NANCY BEVAN IN TRUST  
271830099050000
- ⑨ TRANSPORTATION MINISTRY  
271830100500000
- ⑩ WARREN BAILIE  
271830100300000
- ⑪ OTTAWA POOL & PATIO LTD.  
271830006100000
- ⑫ CRAIG & ORLINDA HOBBS  
271830007500000
- ⑬ MICHAEL HOSHKO  
271830011000000
- ⑭ OTTAWA CITY  
271830013000000
- ⑮ OTTAWA CITY  
271830494840000
- ⑯ OTTAWA CITY  
271830064580000

SHEILA  
KOUCHOUKO  
2718300040000

THEODORL  
VAN LUNE  
27183000500

PHAT & CL  
271830005C

OTTAWA POOL  
AND PATIO LTD  
271830006000000

CRAIG &  
ORLINDA HOBBS  
271830007000000

STANLEY RICHIE &  
ETHEL GRIERSON  
271830008000000

POOLE CREEK  
MANAGEMENT  
271830009000000

LDR PROPERTIES INC  
271830010000000

DONATO CATIZZONE  
271830012000000

JAMES P.  
VOROBJ  
271830002010000

UNOPEN ROAD ALLOWANCE

TRANS CANADA TRAIL  
ABANDONED CN RAILWAY

Drainage  
Basin

M. MOLOT &  
J. LEVINSON  
271825204000000

DAVID  
MORLEY  
271825208000000

OTTAWA CITY  
271825230000000

2166723  
ONTARIO LTD.  
271825210000000

LEGEND:  
—— MUNICIPAL DRAIN  
- - - DRAINAGE BASIN

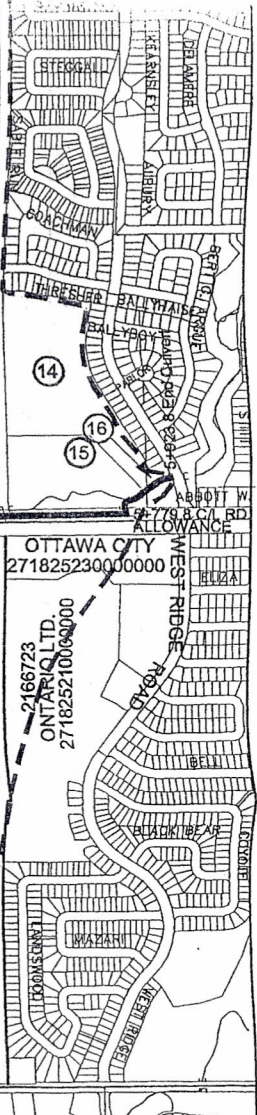

Permit-Seal



Stantec

Copyright Reserved

The Contractor shall verify and be responsible for all dimensions. DO NOT scale the drawing - any errors or omissions shall be reported to Stantec without delay. The Copyrights to all designs and drawings are the property of Stantec. Reproduction or use for any purpose other than that authorized by Stantec is forbidden.

Stantec  
400-1505 Laperriere Avenue  
Ottawa ON Canada  
K1Z 7T1  
Tel. (613) 722-4420  
Fax. (613) 722-2799  
www.stantec.com

Client/Project  
CITY OF OTTAWA

HAZELDEAN ROAD MUNICIPAL DRAINAGE  
AND WATERCOURSE MANAGEMENT PLAN

Ottawa, Ontario

Title

PLAN

Project No.  
163400835

Scale  
0 100 200 300m

Drawing No.  
1

Sheet  
1 of 2

Revision  
0

File Name:	P.A.J. Dwn.	J.V.G. Chkd.	J.V.G. Dsgn.	10.06.30 YY.MM.DD
------------	----------------	-----------------	-----------------	----------------------